



D A S H S Y M O N S  
s y s t e m s

# BASIC ACCESS CONTROL AND ALARM SYSTEM WITH FLOOR PLAN

Access Control can appear overwhelming at first sight, however nothing could be further from the mark.

The real advantages in an Access System are:

- ◆ Not having to locate keys.
  - Simply hold the handbag or briefcase the proximity card or tag is located in, up to the reader and you will be granted access.
- ◆ No more hiding keys for the cleaner or landscaper.
  - Instead issue the cleaner or maintenance person, etc, a card and only allow it to work when they are supposed to be there. Also the house can lock itself after they have left.
- ◆ No more changing the locks when you lose a key.
  - You, the master user, stipulate the access of each card. Lose a card simply delete it.
- ◆ Full reporting features.
  - Want to know exactly who is in the house and when? Reporting allows you to see what times and what cards enter and exit the premises.
- ◆ Online functionality.
  - You are able to log in and make changes to your system online, making someone forgetting their keys an issue of the past. Perfect for remote locations.
- ◆ Your family's safety.
  - Incorporate access control with your alarm system to achieve a complete solution.



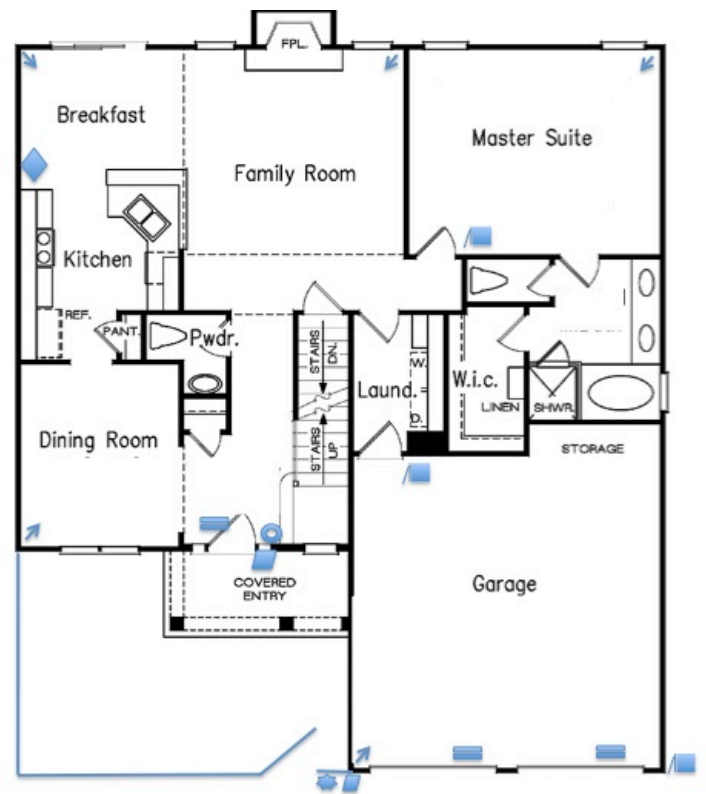

This is a very basic  
Access system.

### Users

User 1 & 2 - Master users - 24/7 Access and programming authority

User 3 & 4 - Restricted users - 24/7 Access with no programming authority

User 5 - Restricted user - 1 day a fought night access, front gate only.  
 (landscaper)

User 6 - Restricted user - 1 day a week access, front gate and entry door  
 access. (cleaner)

- ◆ Proximity Reader at each door for access and an external keypad to open the garage doors with a code for times when cards are misplaced.
- ◆ Video intercom on the front gate to see the caller and let them in without leaving the kitchen (where the base is located).
- ◆ Exit buttons inside the front door to release to gate or door with ease.
- ◆ Strategically placed motion detectors and door position switches for intruder detection when the alarm is on.
- ◆ Keypad for disarming/arming as you enter/exit the home from the garage.
- ◆ Keypad in the master bedroom to arm the alarm at night. Allowing movement in the kitchen family room and master while still monitoring the other sensors.
- ◆ Remember Access systems can begin very basically, as little as 1 door and one reader, and be built upon over time to incorporate more and more of your home.

